

ACCESSIBLE BRICK CHAMBER
 [DEPTH FROM GROUND LEVEL TO SOFFIT OF PIPE LESS THAN 1.00M]

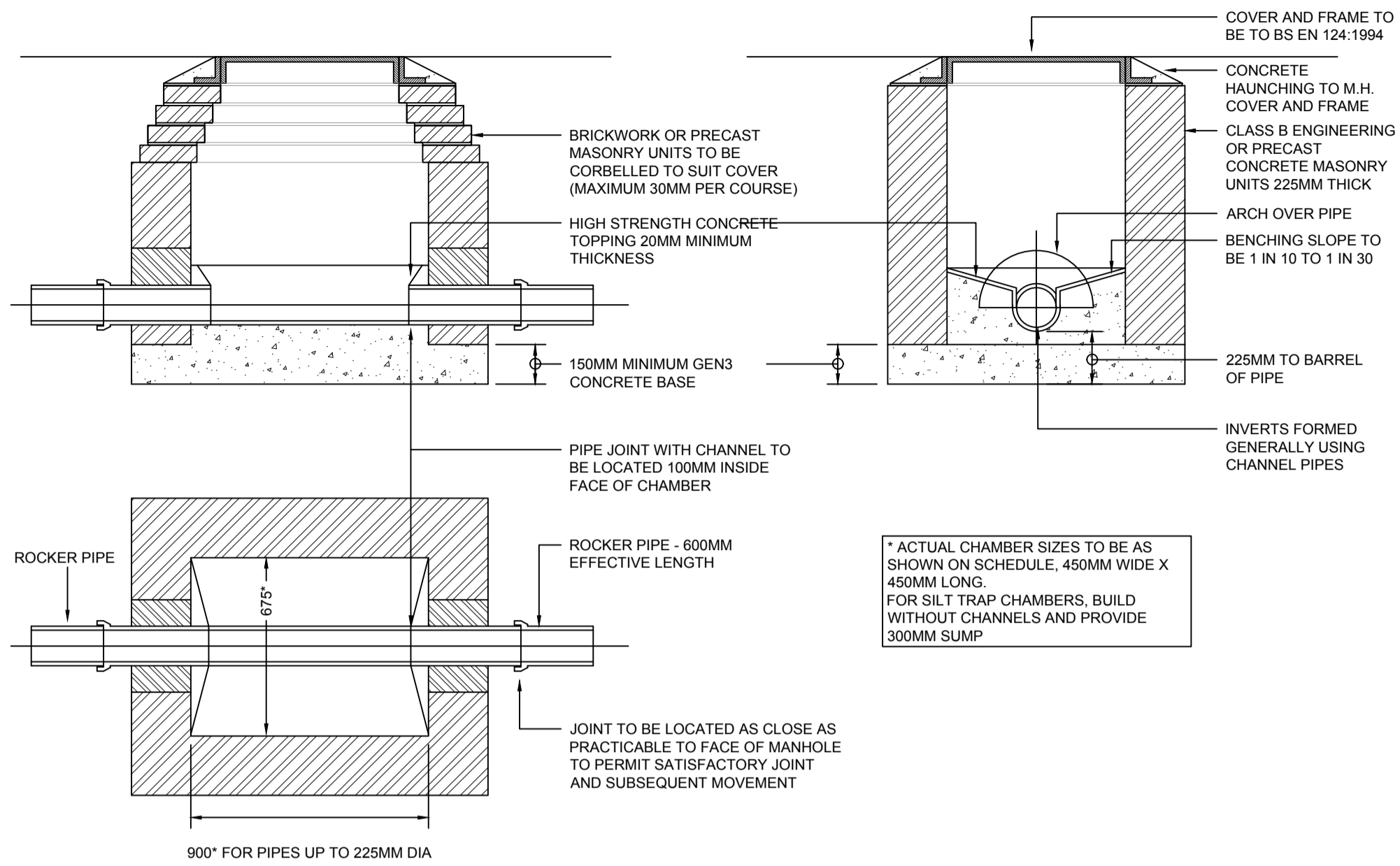

TUBOSIDER TWINSTORE ATTENUATION
 [REFER TO TUBOSIDER DRAWINGS FOR FULL DETAILS]

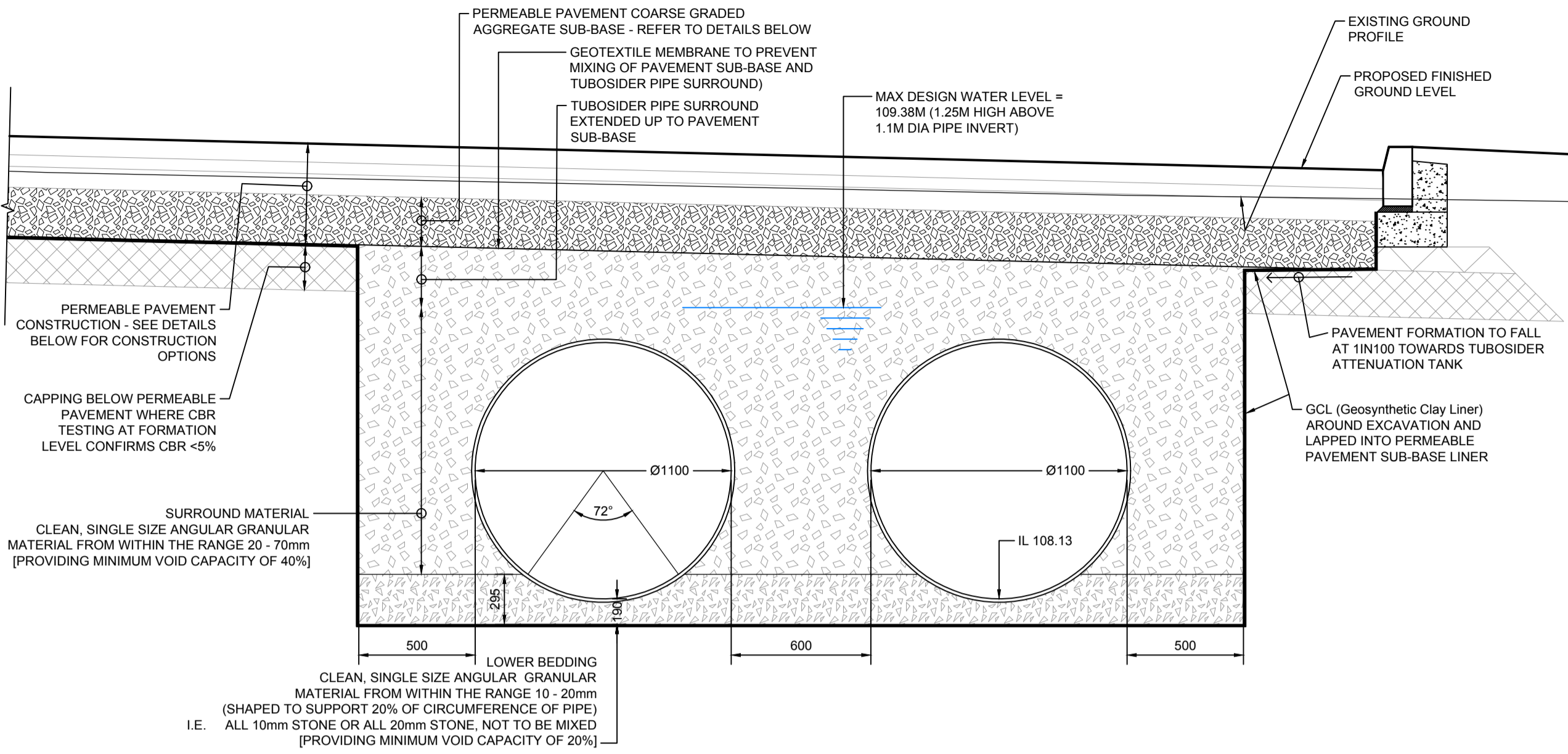

GENERAL NOTES:

- DO NOT SCALE THIS DRAWING FOR DISCREPANCIES OR OMISSIONS CONTACT THE ENGINEER PRIOR TO WORK COMMENCING.
- MATERIALS AND WORKMANSHIP ARE TO COMPLY IN ALL RESPECTS WITH CURRENT PROJECT SPECIFICATIONS, CURRENT CODES OF PRACTICE AND BUILDING REGULATIONS.
- THE COPYRIGHT OF THIS DRAWING IS VESTED IN THE ENGINEER AND MUST NOT BE COPIED OR REPRODUCED WITHOUT WRITTEN CONSENT.
- THE CONTRACTOR IS TO CHECK AND VERIFY ALL BUILDING AND SITE DIMENSIONS, LEVELS AND SEWER INVERT LEVELS AT CONNECTION POINTS BEFORE WORK COMMENCES.
- THIS DRAWING IS TO BE READ IN CONJUNCTION WITH ALL RELEVANT SPECIFICATIONS AND DRAWINGS ISSUED BY THE ENGINEER, ARCHITECT AND OTHER DESIGN DISCIPLINES.

DRAINAGE NOTES:

- ALL DRAINAGE WITHIN THE SITE TO BE CONSTRUCTED IN CLAYWARE PIPES.
- ALL BELOW GROUND DRAINAGE WORKMANSHIP TO BE CARRIED OUT IN STRICT ACCORDANCE WITH BS 8000 'WORKMANSHIP OF BUILDING SITES, PART 14: CODE OF PRACTICE FOR BELOW GROUND DRAINAGE'.
- EXACT LOCATIONS AND CURRENT USAGE OF ALL EXISTING DRAINAGE TO BE ESTABLISHED ON COMMENCEMENT OF ANY WORKS.
- ALL NEW BELOW GROUND DRAINAGE WORKS TO BE INSPECTED AND APPROVED BY BUILDING CONTROL PRIOR TO BACKFILLING.
- DRAINS UNDER BUILDINGS MUST BE ENCASED IN 150mm OF CONCRETE.
- DRAINS ARE TO PASS BELOW REINFORCED CONCRETE GROUND BEAMS.
- COVER LEVELS GIVEN TO MAN-HOLES ARE TO BE ADJUSTED TO SUIT FINAL FINISHED SITE LEVELS.
- COVERS TO MAN-HOLES WITHIN SITE BOUNDARIES ARE TO BE AS FOLLOWS:
 CLASS D400 TO HEAVILY TRAFFICKED AREAS (DELIVERY VEHICLES)
 CLASS C250 TO LIGHTLY TRAFFICKED AREAS (CARS ONLY)
 CLASS B125 TO FOOTPATH & PAVED AREAS
 CLASS A15 TO LANDSCAPED AREAS
 NOTE THAT C250 AND D400 COVERS ARE TO BE SECTIONAL COVERS TO REDUCE MANUAL HANDLING.
- WHERE COVERS LOCATED WITHIN BLOCK / SETT PAVED AREAS TO BE RECESSED (IF DIRECTED BY LANDSCAPE ARCHITECT), ALLOW PETER SAVAGE 'SHILTON' KITEMARKED RANGE KS30 OR SIMILAR APPROVED WHERE B125 / D400 COVERS ARE REQUIRED.
- WHERE INTERNAL CHAMBERS (WITHIN THE BUILDING) ARE REQUIRED, THEY ARE TO HAVE MECHANICALLY FIXED AIRTIGHT COVERS. THESE MAY BE RECESSED TO SUIT THE ARCHITECTS REQUIREMENTS FOR FINISHES, EG PETER SAVAGE R2T-450.

- MINIMUM CLEAR OPENINGS:
 600x600mm FOR PRIVATE DEVELOPMENT
 675x675mm FOR ADOPTABLE CHAMBERS
- ALL PIPES DIRECTLY FROM RAIN WATER PIPES (RWP), SOIL & VENT PIPES (SVP) AND INTERNAL TRAPPED GULLIES (IG) ARE TO BE 100mm DIA CLAYWARE UNLESS STATED OTHERWISE ON THE PLAN.
 - ALL OUTLET PIPES DIRECTLY FROM STORM WATER ROAD GULLIES (S) ARE TO BE 150mm DIA PLASTIC UNLESS STATED OTHERWISE ON THE PLAN.

TYPICAL PERMEABLE PAVEMENT SECTION:

PERMEABLE PAVEMENT CONSTRUCTION FOR CAR PARKING BAYS* TO SUIT LOAD TRAFFIC CATEGORY 4 (BS7533).

POROUS ASPHALT (AS AN ALTERNATIVE TO PERMEABLE BLOCK PAVING):

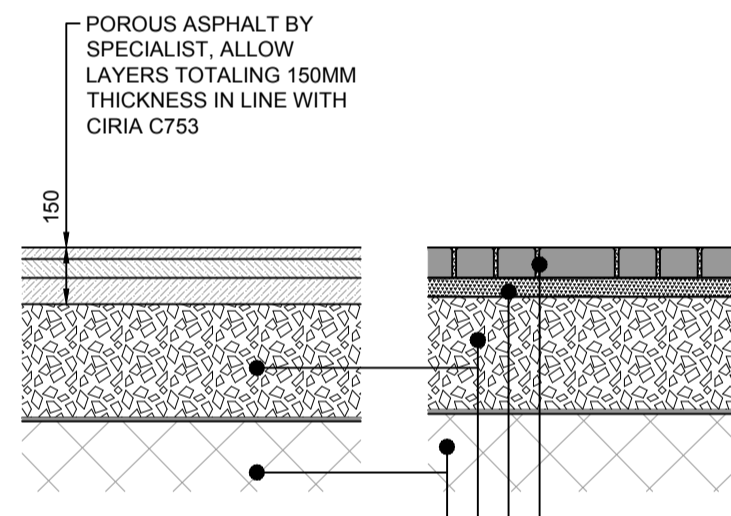

WHERE CBR < 5%, PROVIDE:
 150MM CAPPING FOR CBR 4%
 225MM CAPPING FOR CBR 3%
 300MM CAPPING FOR CBR 2.5%
 SEEK ADVICE FOR LOWER CBR VALUES

PERMEABLE BLOCK PAVING:

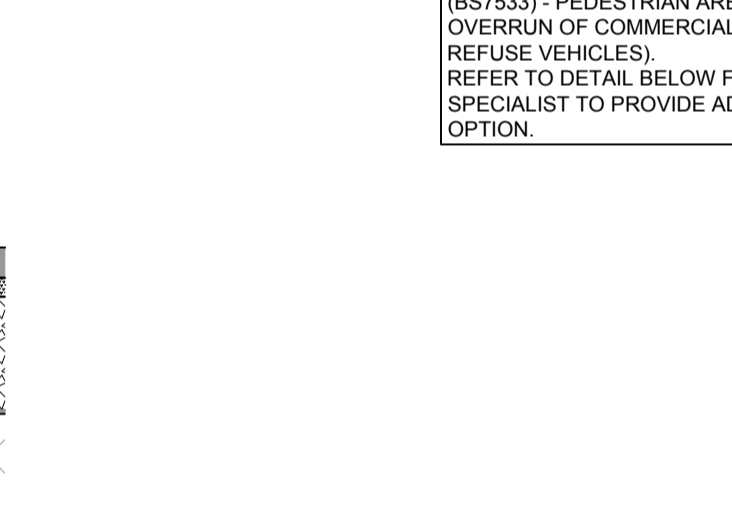

ALL PERVIOUS PAVING UNITS TO BE INSTALLED IN ACCORDANCE WITH MANUFACTURER'S RECOMMENDATIONS AND BS 7533-3, WITH PARTICULAR CARE TAKEN NOT TO CONTAMINATE JOINTS (EG BY SOIL FOR SOFT LANDSCAPING, ETC). ALSO, THE SEQUENCING OF CONSTRUCTION WORKS IN TERMS OF PLANT MOVEMENT AND/OR STORAGE OF MATERIALS MUST NOT COMPROMISE THE PAVEMENT INTEGRITY.

*THE PERMEABLE PAVEMENT CONSTRUCTION TO THE MAIN ACCESS AISLE REQUIRES AN ADDITIONAL (PERFORATED) ROADBASE TO BE SUITABLE FOR LOAD TRAFFIC CATEGORY 6 (BS7533) - PEDESTRIAN AREAS SUBJECT TO REGULAR OVERRUN OF COMMERCIAL VEHICLES (IE DELIVERY AND REFUSE VEHICLES). REFER TO DETAIL BELOW FOR BLOCKED PAVED OPTION. SPECIALIST TO PROVIDE ADVICE FOR POROUS ASPHALT OPTION.

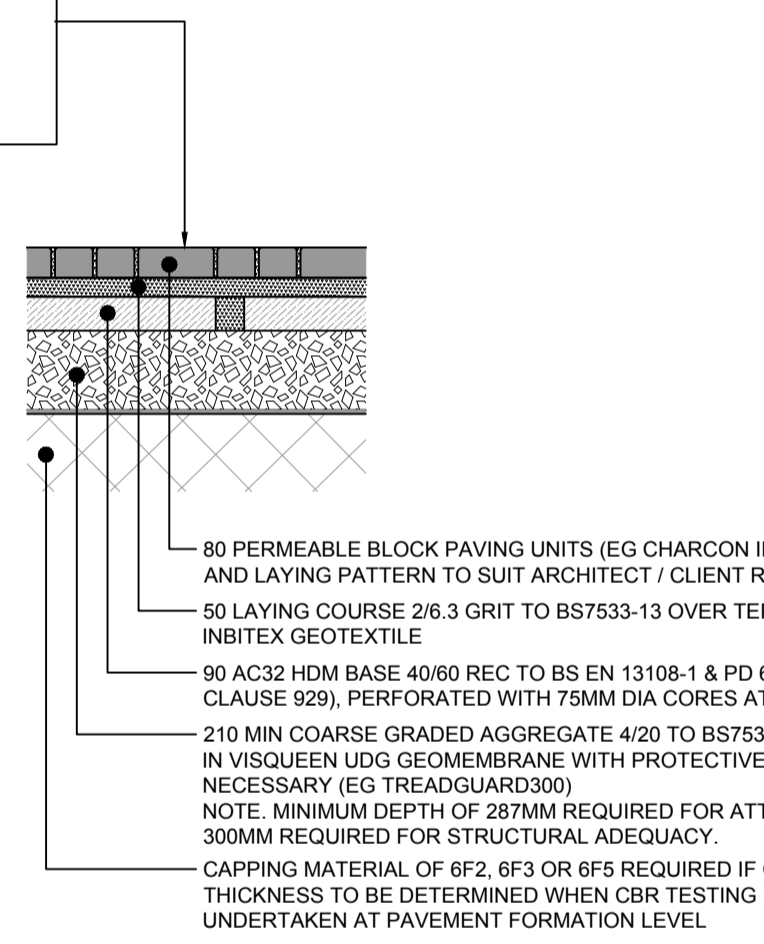

CONCRETE SLAB CONSTRUCTION

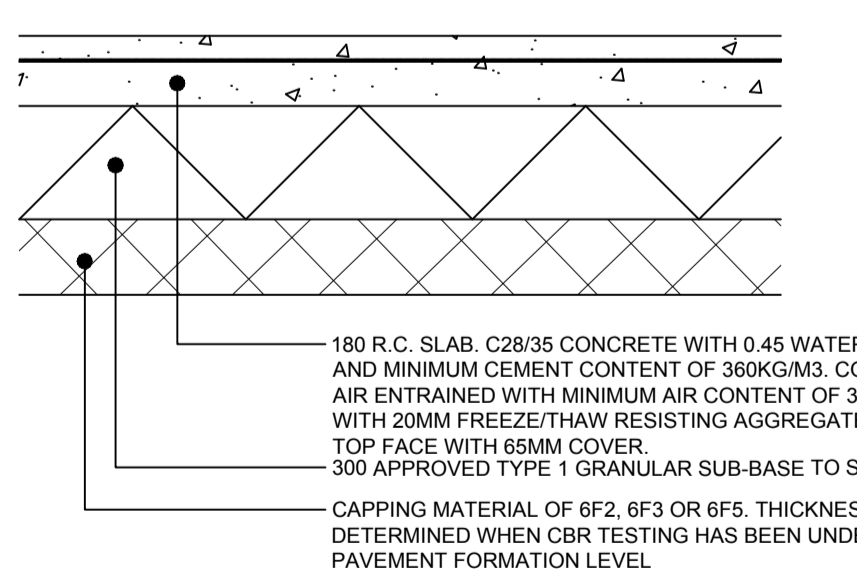

FOOTWAY CONSTRUCTION

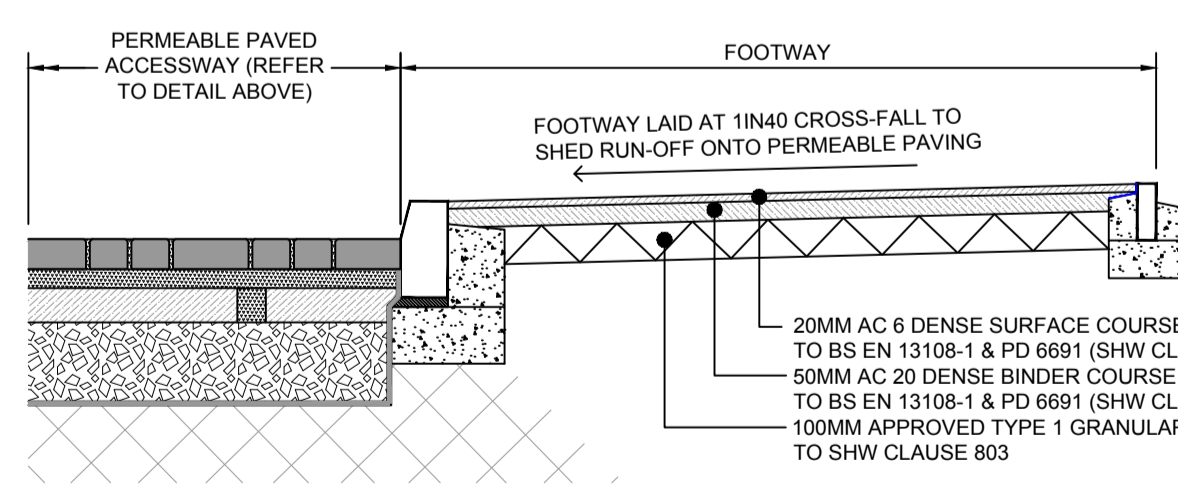

KERB DETAILS

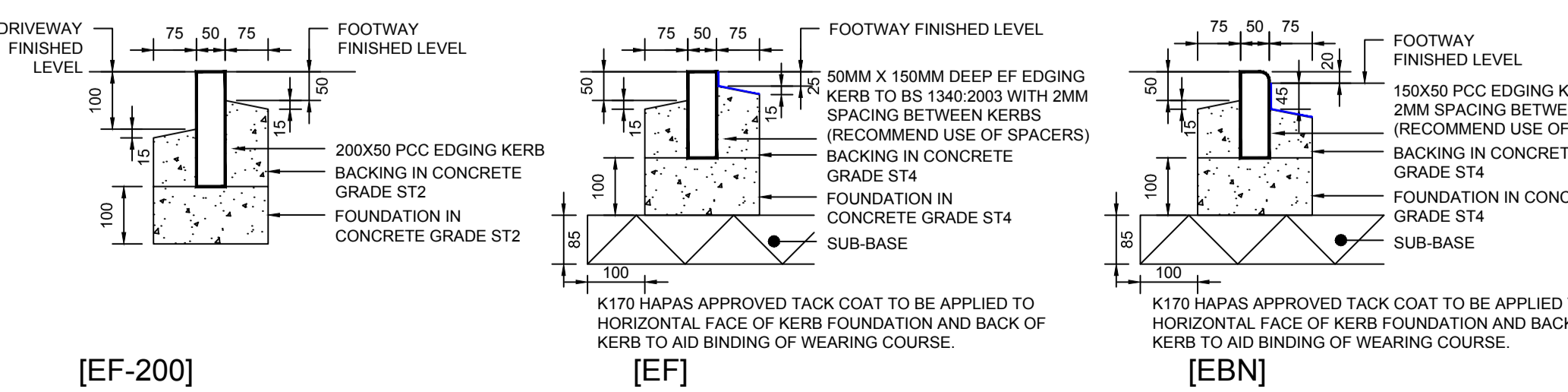

THIS DRAWING IS TO BE READ IN CONJUNCTION WITH DRAWINGS "19254-C01 to -C02"

CONSTRUCTION (DESIGN & MANAGEMENT) REGULATIONS, 2015.

SIGNIFICANT ITEMS OF RESIDUAL RISK FOLLOWING DESIGN REVIEW NOTED THUS:

--	--

Rev	Date	Amendment	By
C	11.01.2021	Kerb & Pavements Details	CJE
B	07.10.2020	Tubosider & Permeable Pavements Details	CJE
A	15.01.2020	Orifice control detail updated	CJE

oes CONSULTING

Dudley Court
 31 The Inghed
 Dudley
 West Midlands
 DY1 1RR

Tel: 0121 285 1980
 www.o-e-s.co.uk
 e-mail: info@o-e-s.co.uk

The Institution of Structural Engineers

PRELIMINARY ISSUE

Client: Accord Group
 Project: Former Victoria Works Car Park, Edward Street Redditch
 Title: Proposed Drainage Details Sheet 2

Date: 09.12.19	Drawn: CJE	Checked: NG	Approved: S.S.B
Drawing Number: 19254-C03	Scale: NTS	Size: A1	Revision: C