

ALL DIMENSIONS ARE TO BE CHECKED ON SITE PRIOR TO CONSTRUCTION. THE CONTRACTOR IS TO NOTIFY THE DESIGN TEAM OF ANY DISCREPANCY BETWEEN DRAWINGS, SPECIFICATION AND SITE DIMENSIONS. DO NOT SCALE FROM THIS DRAWING.

PLAN LEGEND

SHADED AREA DENOTES EXISTING STRUCTURE

FOR ALL STRUCTURAL DETAILS AND SPECIFICATIONS; REFER TO ADEPT CONSULTING LTD (S.E) DRAWINGS NOS. 4189B SERIES DRAWINGS, LATEST REVISIONS

NOTE: FABRICATOR TO CHECK ALL DIMENSIONS AND LEVELS ON SITE PRIOR TO FABRICATION

DRAWING TO BE READ INCONJUNCTION WITH LOCAL HOMES DRAWINGS / DETAILS

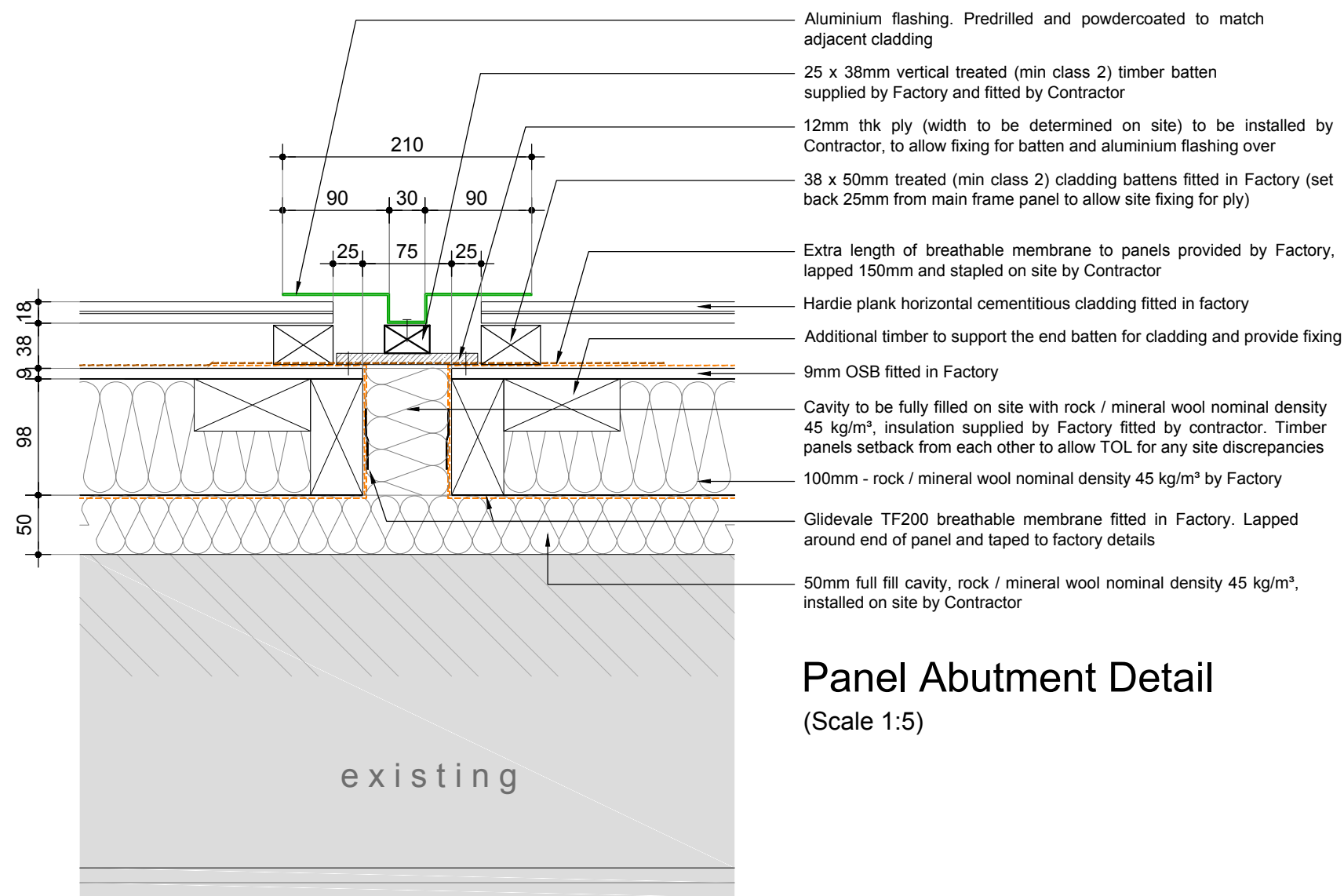

- Aluminium flashing. Predrilled and powdercoated to match adjacent cladding
- 25 x 38mm vertical treated (min class 2) timber batten supplied by Factory and fitted by Contractor
- 12mm thk ply (width to be determined on site) to be installed by Contractor, to allow fixing for batten and aluminium flashing over
- 38 x 50mm treated (min class 2) cladding battens fitted in Factory (set back 25mm from main frame panel to allow site fixing for ply)
- Extra length of breathable membrane to panels provided by Factory, lapped 150mm and stapled on site by Contractor
- Hardie plank horizontal cementitious cladding fitted in factory
- Additional timber to support the end batten for cladding and provide fixing
- 9mm OSB fitted in Factory
- Cavity to be fully filled on site with rock / mineral wool nominal density 45 kg/m³, insulation supplied by Factory fitted by contractor. Timber panels setback from each other to allow TOL for any site discrepancies
- 100mm - rock / mineral wool nominal density 45 kg/m³ by Factory
- Glidevale TF200 breathable membrane fitted in Factory. Lapped around end of panel and taped to factory details
- 50mm full fill cavity, rock / mineral wool nominal density 45 kg/m³, installed on site by Contractor

Panel Abutment Detail
(Scale 1:5)

rev	note	date	by
-----	------	------	----



178 Birmingham Road
West Bromwich
West Midlands
B70 6QG
Tel. 0300 111 7000
www.accordna.org.uk

client
Accord Group

project
Black Country Retrofit Wrap and Associated Works
100 - 122 Darlaston Road, Kings Hill, WS10 7SR

title
Panel Abutment Detail

job	dwg no	rev	date	scale	Aug 20
18-1540	518		drawn	1:5 @ A3	RP