

ALL DIMENSIONS BASED ON SURVEY DRAWINGS. ALL DIMENSIONS TO BE VERIFIED ON SITE PRIOR TO ANY FABRICATION. INDESIGN WILL NOT TAKE RESPONSIBILITY FOR ANY DISCREPANCIES RELATING TO EXISTING SURVEY DRAWINGS.

ALL DIMENSIONS TO BELOW SHOWN TO PROPOSED TIMBER FRAME STRUCTURAL OPENING SIZES ONLY (ALLOWING FOR 50MM TOLERANCE FROM THE EXISTING BRICKWORK OPENINGS) - EXCEPT WHERE SHOWN OTHERWISE

FOR DIMENSIONS RELATING TO THE EXISTING BUILDING - REFER TO SURVEY DRAWING NOS: N9557-1_R1 LASER SURVEYS-DARLASTON RD-FLOOR PLANS N9557-2_R1 LASER SURVEYS-DARLASTON RD-ELEVATIONS

ALL DIMENSIONS ARE TO BE CHECKED ON SITE PRIOR TO CONSTRUCTION. THE CONTRACTOR IS TO NOTIFY THE DESIGN TEAM OF ANY DISCREPANCY BETWEEN DRAWINGS, SPECIFICATION AND SITE DIMENSIONS. DO NOT SCALE FROM THIS DRAWING.

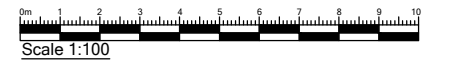

FOR ALL STRUCTURAL DETAILS AND SPECIFICATIONS; REFER TO ADEPT CONSULTING LTD (S.E) DRAWINGS NOS. 4189B SERIES DRAWINGS, LATEST REVISIONS

FOR ALL MECHANICAL AND ELECTRICAL DETAILS & SPECIFICATIONS; REFER TO APPOINTED M&E SPECIALIST SUBCONTRACTOR DRAWINGS / DETAILS

M&E SUBCONTRACTOR TO CHECK INTERNAL CONSTRAINTS AND CONFIRM TO PRINCIPAL CONTRACTOR PRIOR TO ALL INSTALLATION

NOTE: SUB CONTRACTOR / FABRICATOR TO CHECK ALL DIMENSIONS AND LEVELS ON SITE PRIOR TO COMMENCEMENT OF WORKS OR FABRICATION

DRAWING TO BE READ INCONJUNCTION WITH LOCAL HOMES TIMBER PANEL DETAILS

SPECIALIST ROOFING CONTRACTOR TO ENSURE ANY EXISTING SERVICES / SOIL VENT PIPES ARE EXTENDED AS NECESSARY, ALLOWING FOR WATER PROOFING AND FITTING OF ANY SECONDARY WEATHERING COLLARS ETC.

PLAN LEGEND

- SHADED AREAS DENOTE EXISTING WALLS
- DENOTES EXTERNAL WALL INSULATION PANELS OVER EXTERNAL FACE OF EXISTING STRUCTURE

Timber panel set back 50mm from existing structural openings to allow tolerance for any site / survey discrepancies

All existing windows to remain unless informed otherwise by Accord / Client

Refer to drg no. 18-1540-508 Wall Panel Construction Detail

Existing roof lights to bathrooms to be removed. New mechanical ventilation with humidifier sensors to be provided to bathrooms and to extract through new flat roof vent. Contractor to ensure co-ordination of M&E and roofing works

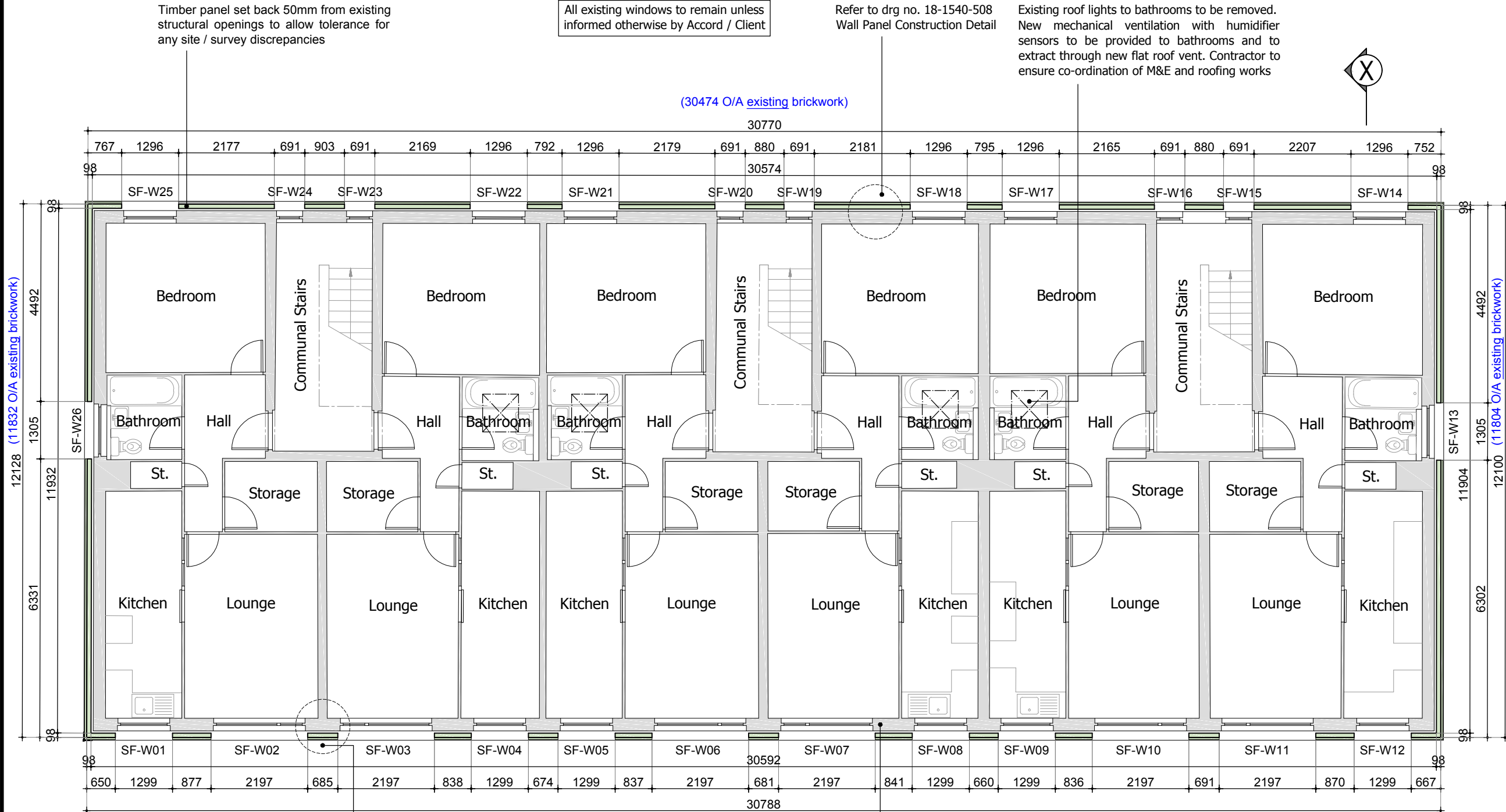

SECOND FLOOR PLAN

Refer to drg no. 18-1540-518 Panel Abutment Detail

Existing cavity fill to be investigated and topped up if required

rev	note	date	by



178 Birmingham Road
West Bromwich
West Midlands
B70 6QG
Tel. 0300 111 7000
www.accordna.org.uk

client
Accord Group

project
Black Country Retrofit Wrap and Associated Works
100 - 122 Darlaston Road, Kings Hill, WS10 7SR

title
Proposed Second Floor Plan

job	dwg no	rev	date	scale	drawn
18-1540	502		Aug 20	1:100 @ A3	RP